



Proudly on Mirarr Country  
ENJOY YOUR STAY

**RECEPTION**  
Dial 80 for assistance

**RESTAURANT**  
Dial 41 for assistance

**BREAKFAST**  
6.30am - 9.30am

**LUNCH**  
12pm - 2pm

**DINNER**  
6pm - 8.30pm

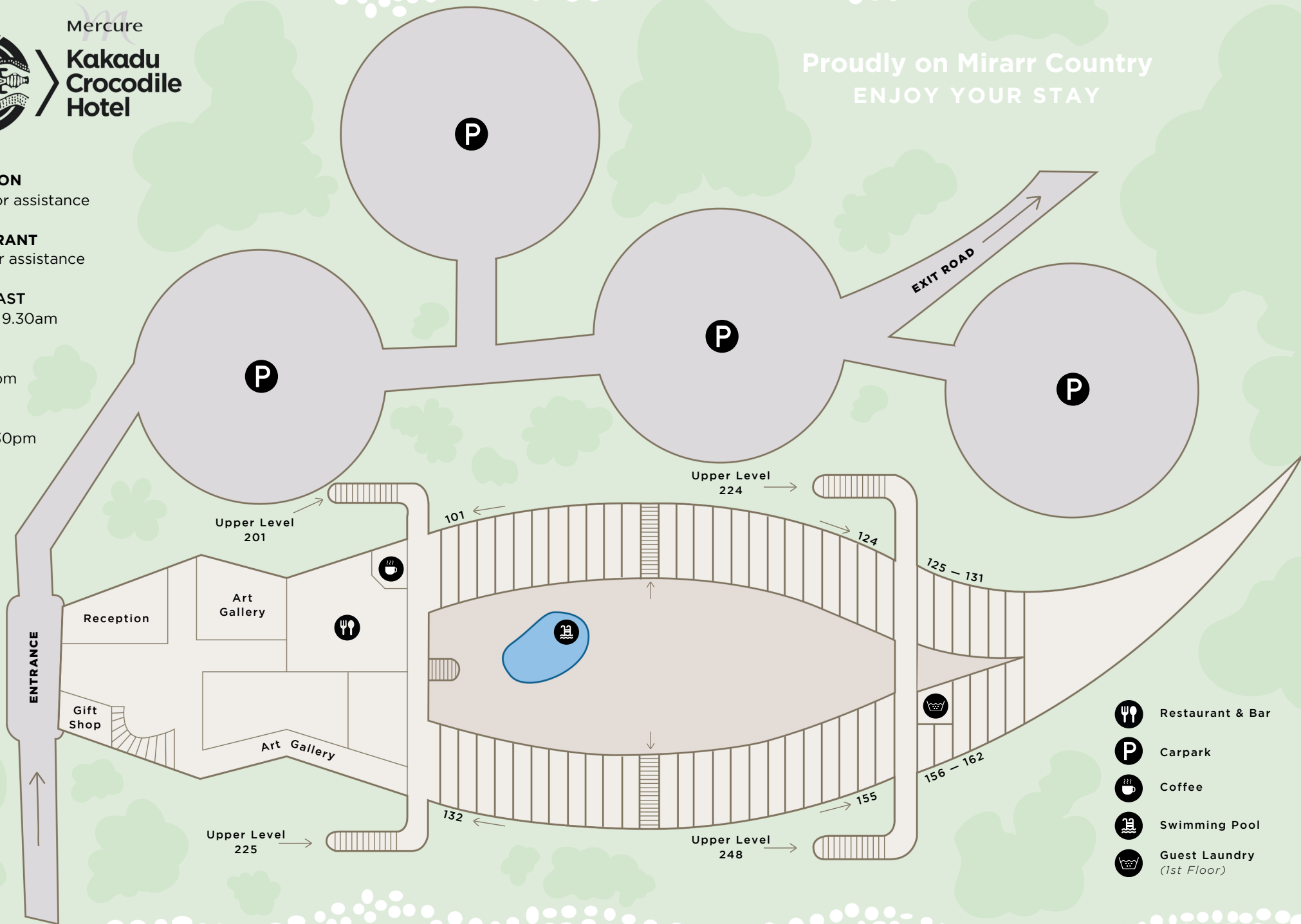

- Restaurant & Bar
- Carpark
- Coffee
- Swimming Pool
- Guest Laundry (1st Floor)

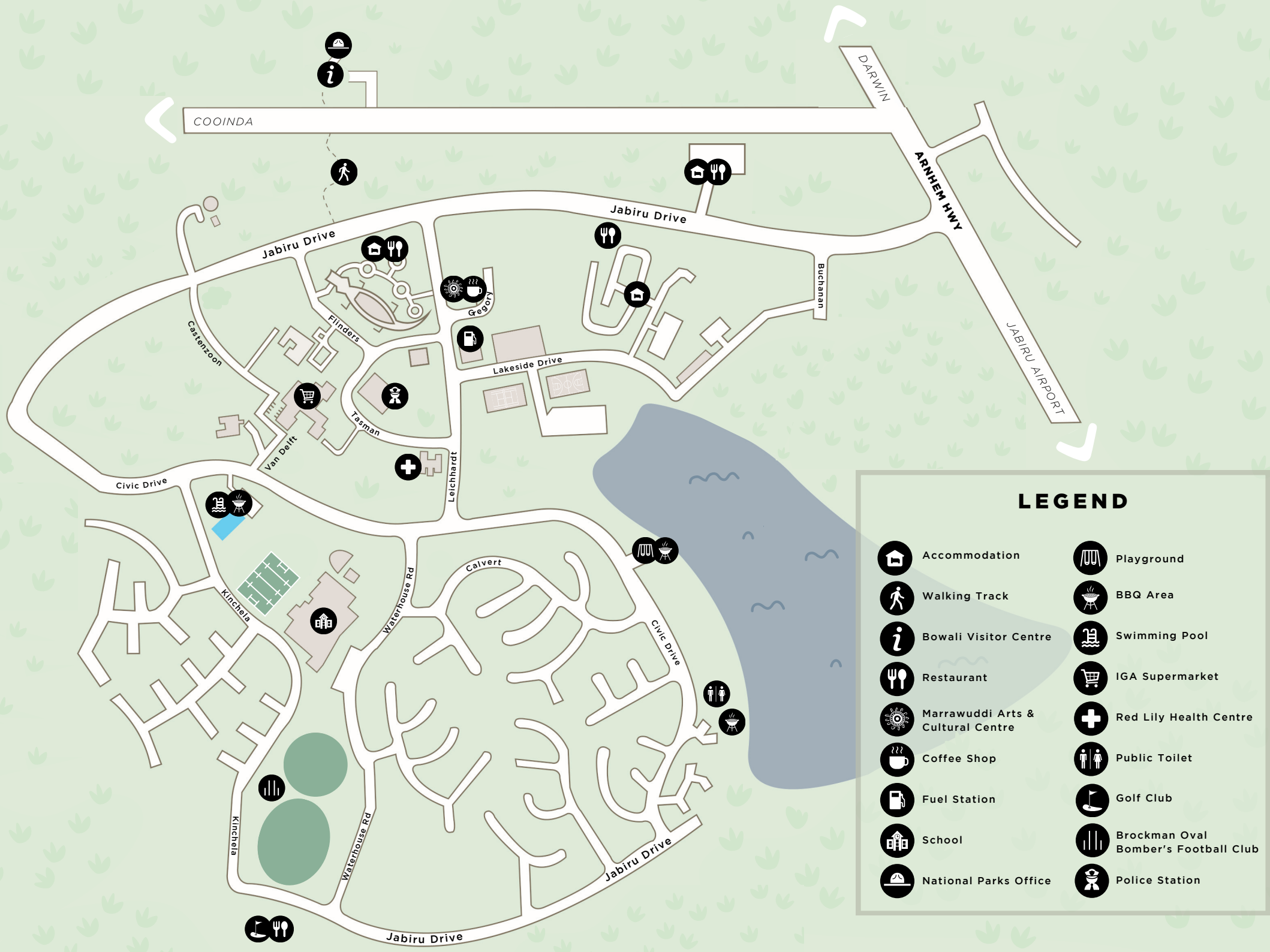

### LEGEND

- |   |                                   |   |                                      |
|---|-----------------------------------|---|--------------------------------------|
|    | Accommodation                     |    | Playground                           |
|   | Walking Track                     |   | BBQ Area                             |
|  | Bowali Visitor Centre             |  | Swimming Pool                        |
|  | Restaurant                        |  | IGA Supermarket                      |
|  | Marrawuddi Arts & Cultural Centre |  | Red Lily Health Centre               |
|  | Coffee Shop                       |  | Public Toilet                        |
|  | Fuel Station                      |  | Golf Club                            |
|  | School                            |  | Brockman Oval Bomber's Football Club |
|  | National Parks Office             |  | Police Station                       |